

Change Table Help Guide

This changing table is intended for showering and changing children and adults weighing up to 200kg, the table must not be used for any other purpose.

1 Pre use checks:

Check for obstructions or items that may become trapped when the changing table is operated. Check the changing table will raise and lower properly using the handset.

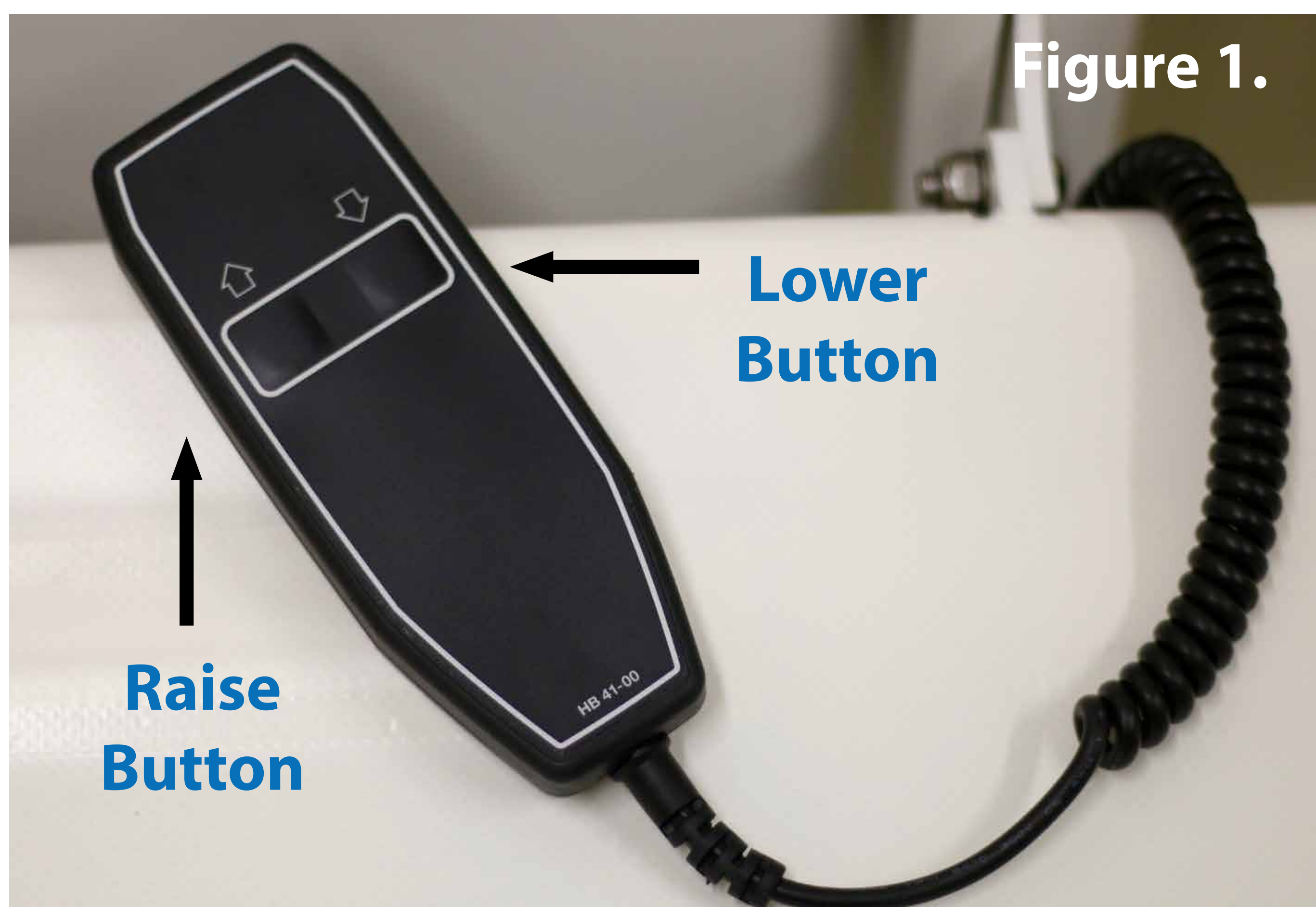

2 Lowering the bed:

To fold down the bed to the usable position, simply hold the bed and lower as indicated by the arrow in Fig 2. To stow bed, lift and fold bed upwards until parallel with cover.



3 Instruction for use:

Operation of the change bed is via the two button hand control. Position the bed at a comfortable height. See Fig 1.



**Changing Places
Transforming Lives**

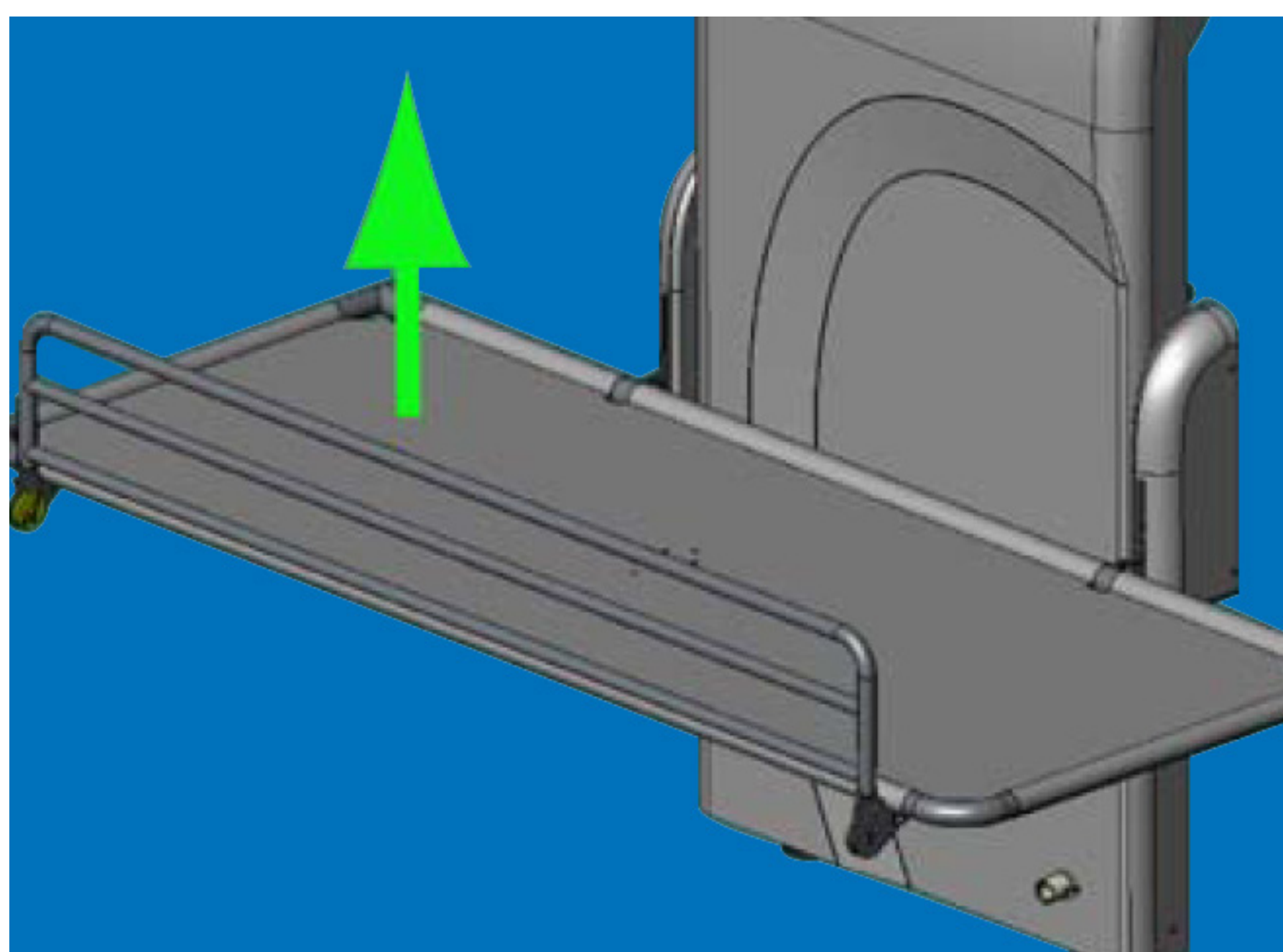

Operating the guard. Folding the guard. Lift the guard upwards.

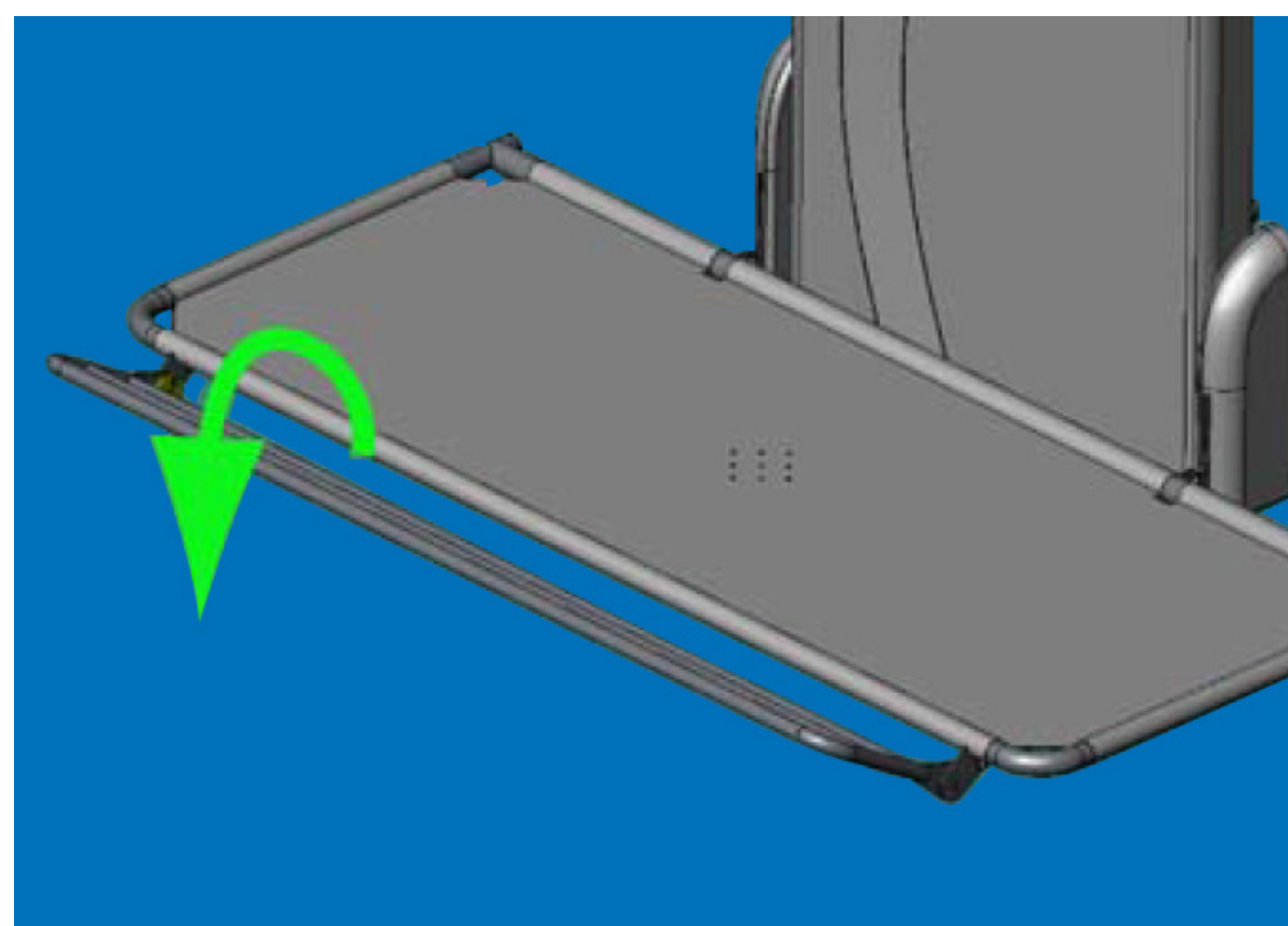

Then rotate it towards you and then fold under the bed.

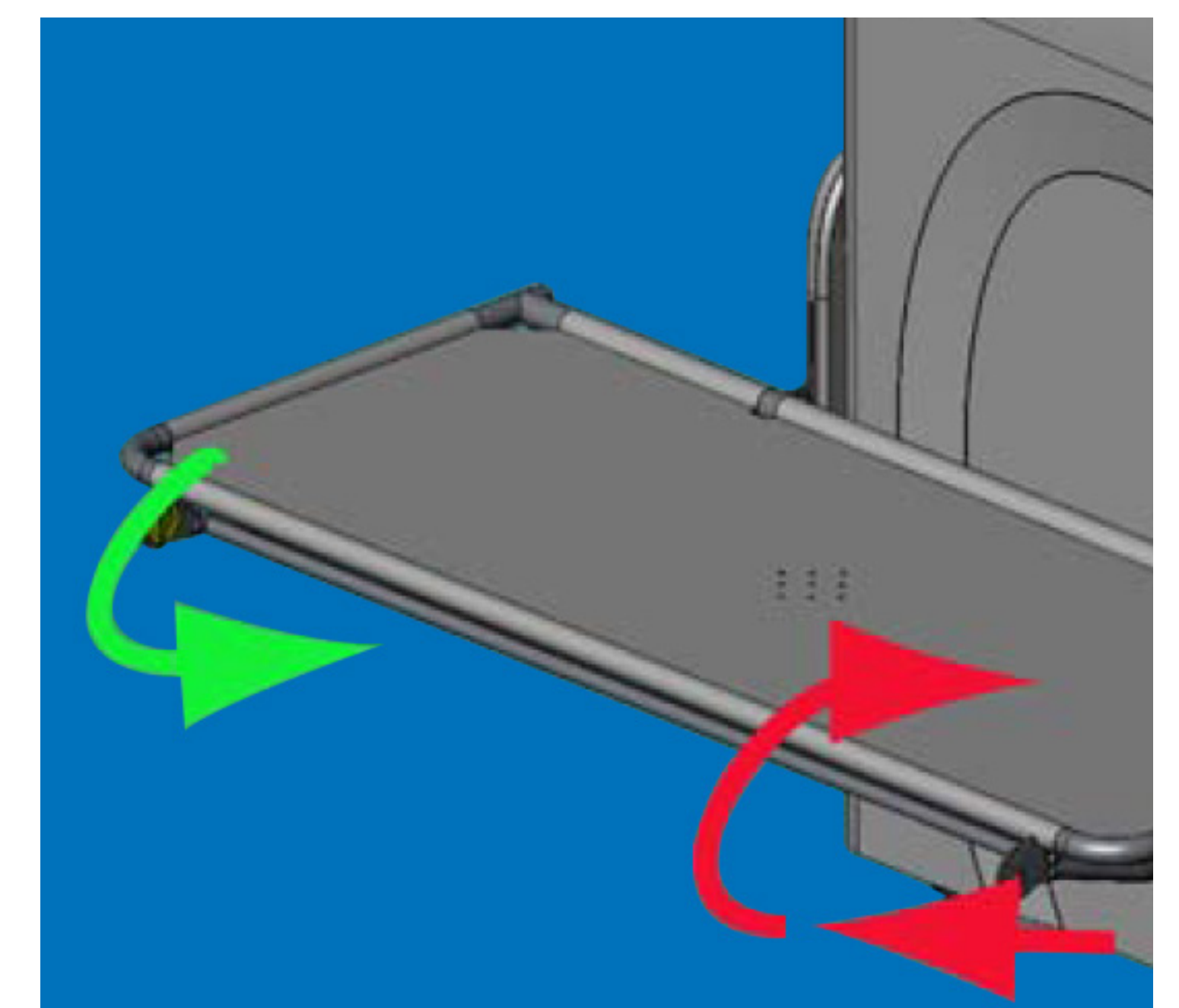

It will then lock under the bed. To replace the guard lift it slightly towards you, it will release, rotate upright and drop into position.

4 After Use:

Wipe the table down using antiseptic spray from wall unit next to table.

**Need Assistance? Call City of
Mandurah all hours 08 9550 3777.**